



WWW.KACEVALVES.COM

WORLD CLASS **VALVES**
WORLD CLASS **SOLUTIONS**

PROCESS RESOURCES INC.

10440 CORPORATE DR
SUGAR LAND, TX 77478

PHONE: +1 (281) 240-0955

EMAIL: SALES@KACEVALVES.COM

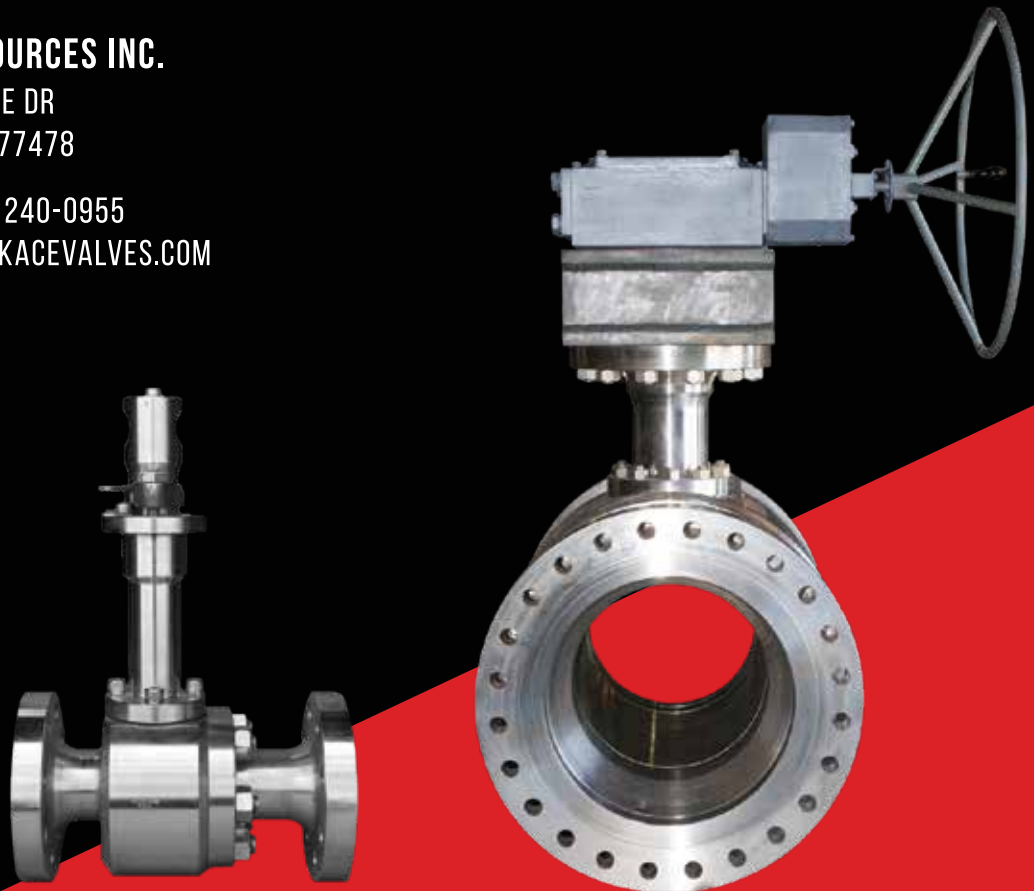

KACE CRYOGENIC BALL VALVES

KACE CRYOGENIC BALL VALVES

APPLICATIONS

- > GAS LIQUIFICATION
- > TRANSFER LINES
- > AIR SEPARATION PLANTS
- > LNG STORAGE & DISTRIBUTION
- > STORAGE TANKS
- > CRYOGENIC TRANSPORTATION TRAILERS
- > FOOD PROCESSING
- > SAMPLE LINES

DESIGN FEATURES

- > ALL STAINLESS STEEL CONSTRUCTION
- > BUBBLE TIGHT SHUTOFF
- > AUTOMATIC CAVITY RELIEF
- > SOLID BALL WITH PRESSURE RELIEF HOLE ON UPSTREAM SIDE
- > ISO 5211 MOUNTING PAD FOR EASY AUTOMATION
- > ANTI STATIC DEVICE
- > ENCAPSULATED BODY GASKET
- > FIRE SAFE DESIGN
- > FLOW ARROW FOR POSITIVE FLOW PATH INDICATION



STANDARDS

STANDARDS	ANSI B16.10 ANSI B16.5 ANSI B16.34 ANSI B53.51
QUALITY CONTROL	BS 6364
MARKING	ISO 9001
INSPECTION & TESTING	MSS SP25 API598/6D



SPECIFICATIONS

CONSTRUCTION	2-PIECE OR 3-PIECE BODY
SIZE	1/2" TO 24" FULL OR REDUCED BORE (LARGER SIZES ON REQUEST)
ANSI CLASSES	150# - 2500#
END CONNECTIONS	THREADED, SOCKET WELD, BUTT WELD, RAISED FACED FLANGED, RTJ
BODY	CF8M, F316, CF8, F304
BALL	ASTM A182 F316
STEM	316 S.S. OR NITRONIC 50
SEATS	PCTFE, KEL-F OR METAL SEATS
TEMPERATURE	DOWN TO -196 C°

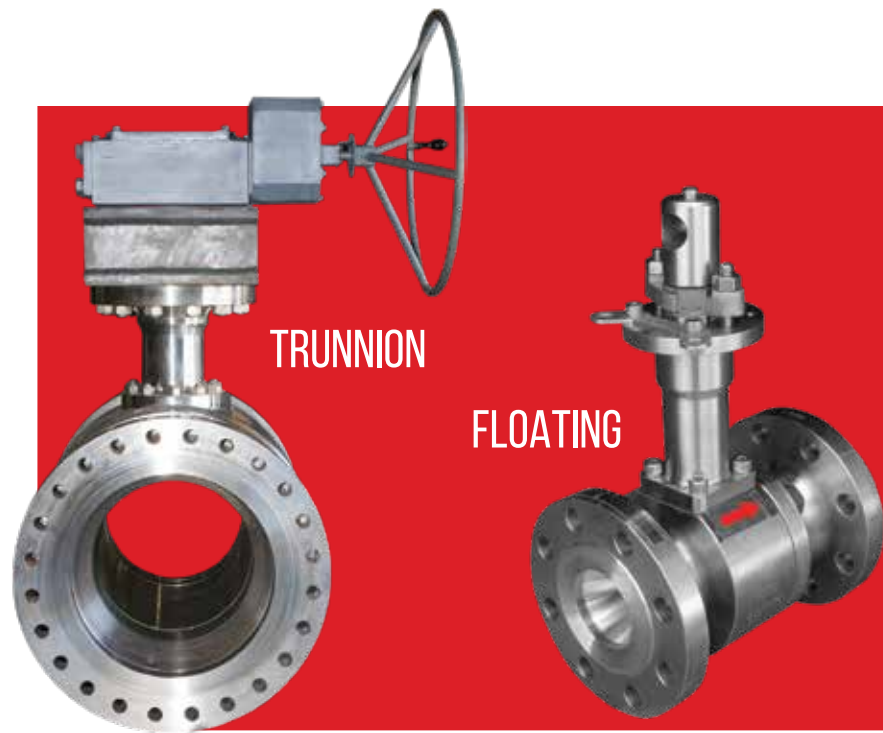

FEATURES

- > SPECIAL ENDS ON REQUEST
- > SPECIAL MATERIALS ON REQUEST
- > PNEUMATIC OR ELECTRIC OPERATORS
- > CLEAN ROOM ASSEMBLY & TESTING
- > HIGH PURITY CLEANING (OIL FREE)

FLOATING BALL VALVE

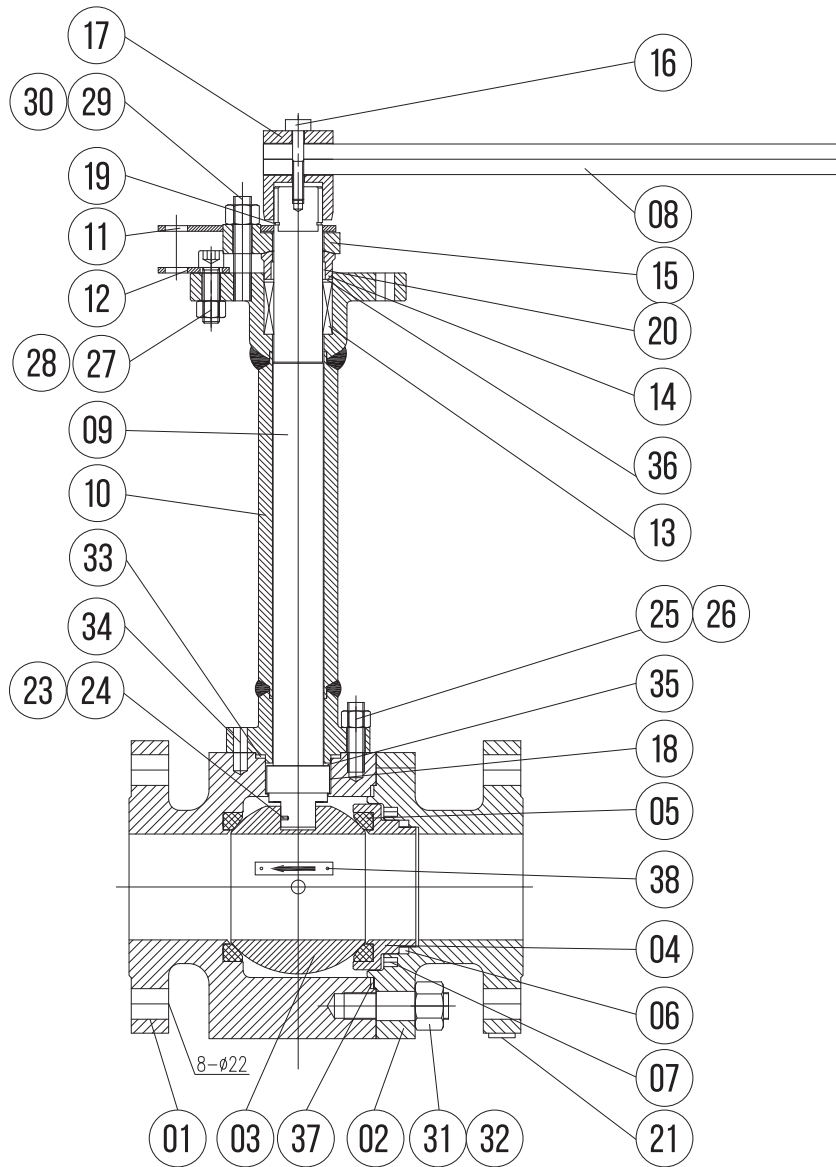

MATERIALS LIST

NO.	PART NAME	QTY	MATERIAL
1	BODY	1	ASTM A182 F316
2	BODY CAP	1	ASTM A182 F316
3	BALL	1	ASTM A182 F316
4	SEAT RETAINER	1	ASTM A182 F316
5	SEAT RING	*2	PCTFE
6	SEAL RING	*1	PTFE
7	SPRING	12	INCONEL X-750
8	HANDLE	1	AISI 1045+ZN
9	STEM	1	ASTM A182 F316
10	BONNET	1	ASTM A182 F316
11	STOP PLATE	1	ASTM A240 304
12	LOCK PLATE	1	ASTM A240 304
13	PACKING	*1	GRAPHITE
14	GLAND FOLLOWER	1	ASTM A182 F316
15	GLAND FLANGE	1	ASTM A182 F304
16	INNER HEXAGONAL BOLT	1	ASTM A320 B8M CL.2
17	HANDLE COVER	1	AISI 1045+ZN
18	BEARING	*1	316+PTFE
19	CIRCLIP	1	ASTM A240 304
20	BEARING	*1	316+PTFE
21	NAME PLATE	1	ASTM A240 304
23	GROUNDING SPRING	1	ASTM A313 316
24	GROUNDING BALL	1	ASTM A276 316
25	NUT	4	ASTM A194 8M CL.2
26	STUD BOLT	4	ASTM A320 B8M CL.2
27	INNER HEXAGONAL BOLT	2	ASTM A370 B8M CL.2
28	NUT	2	ASTM A194 8M CL.2
29	STUD BOLT	2	ASTM A320 B8M CL.2
30	NUT (HEAVY)	2	ASTM A194 8M CL.2
31	STUD BOLT	8	A370 B8M CL.2
32	NUT (HEAVY)	8	ASTM A194 8M CL.2
33	GASKET	*1	316+GRAPHITE
34	PIN	2	ASTM A276 304
35	THRUST WASHER	1	RTFE
36	THRUST WASHER	1	ASTM A240 316
37	GASKET	*1	3161+GRAPHITE
38	FLOW DIRECTION PLATE	1	ASTM A240 304

VENT HOLE TO PRESSURE SIDE

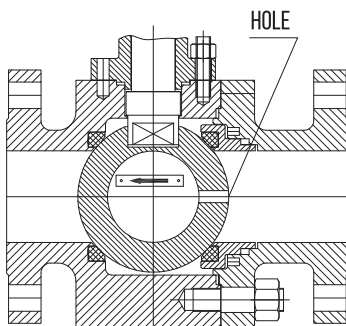

ANSI

SIZE

SIZE	150#	300#	600#	900#	1500#
8"					
6"					
5"					
4"					
3"					
2"					
1 1/2"					
1"					
3/4"					
1/2"					

OTHER SIZES ON REQUEST

FLOATING BALL VALVE

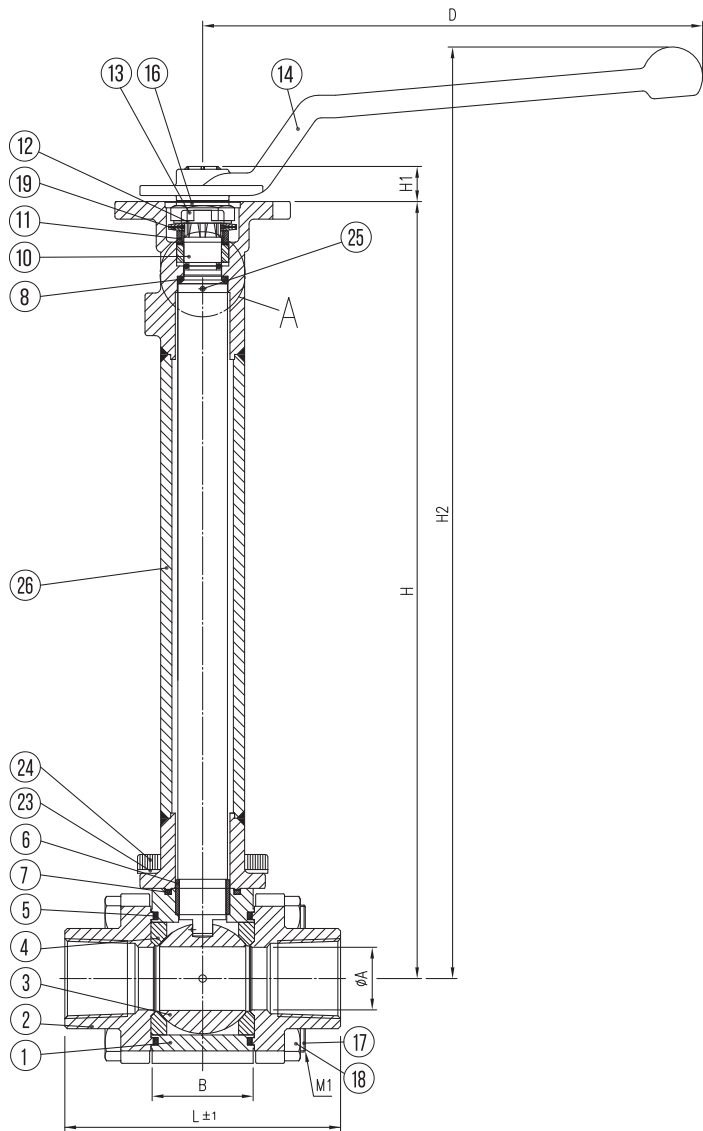

MATERIALS LIST

NO.	PART NAME	QTY.	MATERIAL
1	BODY	1	CF8M
2	END CAP	2	CF8M
3	BALL	1	SS316
4	SEAT	2	PCTFE
5	JOINT GASKET	2	GRAPHITE
6	STEM BEARING	1	PTFE
7	JOINT GASKET	1	GRAPHITE
8	STEM SEAL	1	TFM1 600
9	STEM PACKING	1	GRAPHITE
9.1	STEM PACKING	1	25 % GLASS FIBER FILLED + PTFE
10	STEM	1	17-4PH
11	GLAND	1	SS304
12	LOCK CLIP	1	SS304
13	STEM NUT	1	SS304
14	HANDLE	1	CFS
15	STOP PIN	1	SS304
16	STEM WASHER	1	SS304
17	BOLT	4	SS304
18	BOLT NUT	4	SS304
19	BELLEVILLE WASHER	2	SS301
20	SCREW	1	SS304
21	NUT	1	SS304
22	O-RING	1	VITON
23	SCREW WASHER	4	SS304
24	SCREW	4	SS304
25	ANTI-STATIC DEVICE	2	SS316
26	EXTENDED BONNET	1	CF8M

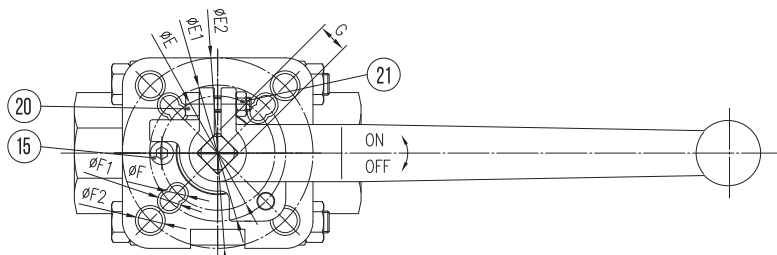
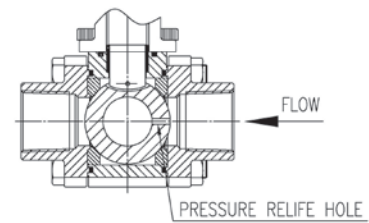
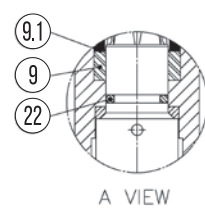

**3-PIECE FULL PORT
& REDUCED PORT**

SIZES	1/4"~2
ENDS	NPT, SW & BW
PRESSURE CLASS	1000WOG
TEMPERATURE	DOWN TO -196 C°

BODY DIMENSIONS (INCHES)

SIZE	ØA	B	D	ØE	ØE1	ØE2	ØF	ØF1	ØF2	G	H	H1	H2	L	M1	ISO5211
1/4"	11.5	24.5	160	36	42	50	65	-	7	9	300	9	345.5	75	M6	F03/F04/F05
3/8"	12.6	24.5	160	36	42	50	65	-	7	9	304	9	345.5	75	M6	F03/F04/F05
1/2"	15	24.5	160	36	42	50	65	-	7	9	300	9	345.5	72.5	M8	F03/F04/F05
3/4"	20	31.4	160	36	42	50	65	-	7	9	304	9	349.5	85.4	M8	F03/F04/F05
1"	25	41.3	200	42	50	70	6	7	9	11	310	11	370	105.3	M8	F03/F04/F07
1-1/4"	32	48.4	200	42	50	70	6	7	9	11	314	11	374	111	M10	F03/F04/F07
1-1/2"	38	56.3	250	50	70	-	75	9	-	14	328.8	14	397.8	127.3	M10	F03/F04/F07
2"	50	71.4	250	50	70	-	75	9	-	14	353.3	14	423.3	145	M12	F03/F04/F07

TRUNNION BALL VALVE

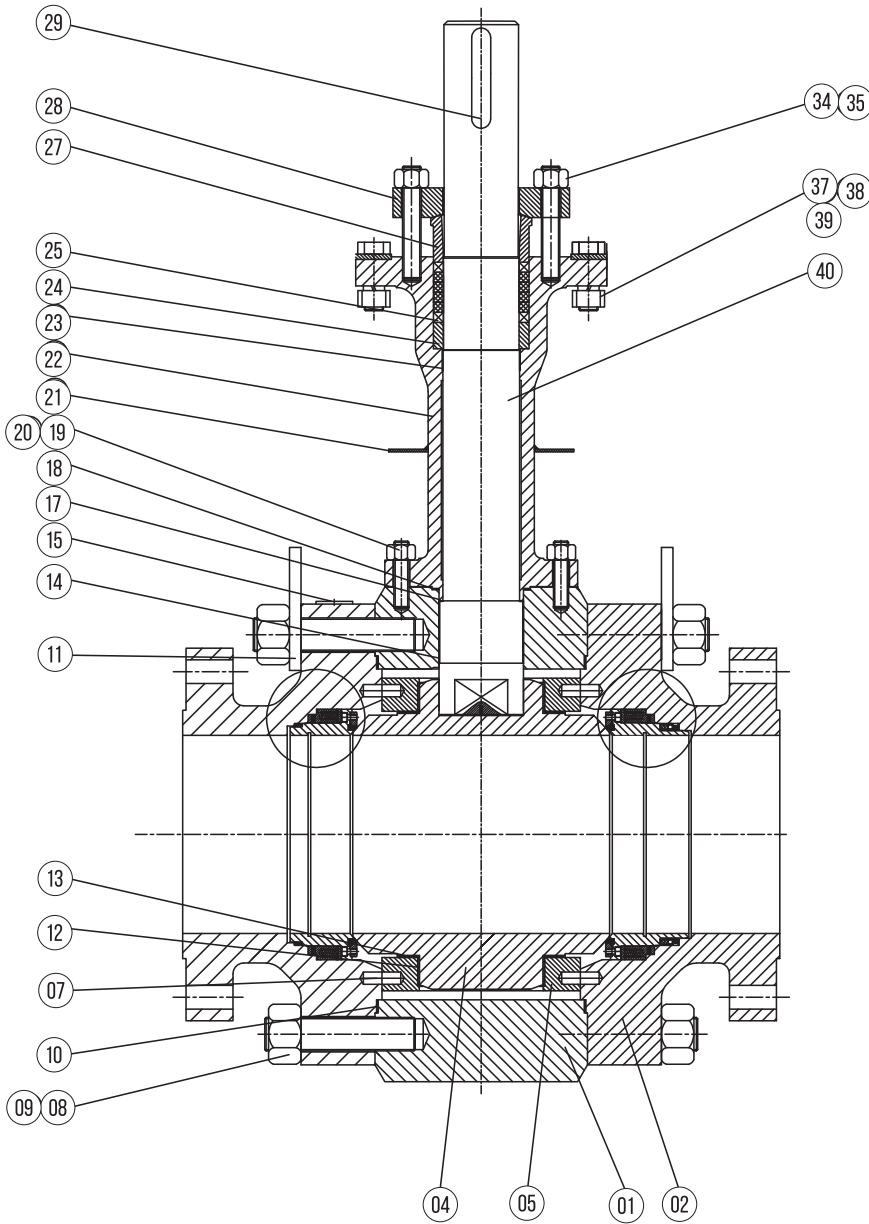

BI - DIRECTIONAL SEAT
DOUBLE - PISTON

UNI - DIRECTIONAL SEAT
SINGLE - PISTON

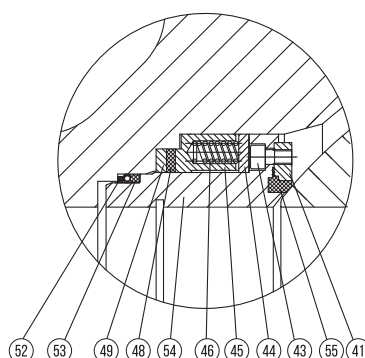
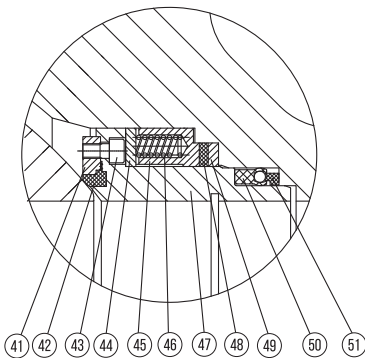

MATERIALS LIST

N	PART NAME	QTY	MATERIAL
1	BODY	1	ASTM A182 F316
2	BODY CAP	2	ASTM A182 F316
4	BALL	1	ASTM A182 F316
5	TRUNNION BLOCK	2	ASTM A182 F316
7	PIN	4	ASTM A276 304
8	STUD BOLT	1S	ASTM A320 B8M
9	NUT (HEAVY)	1S	ASTM A194 B8M
10	GASKET	*2	316+GRAPHITE
11	LIFTING LUG	2	AISI 1035
12	BEARING	*2	316+PTFE
13	THRUST WASHER	*2	RTFE
14	BEARING	*1	316+PTFE
15	NAME PLATE	1	ASTM A240 304
17	THRUST WASHER	*1	RTFE
18	GASKET	*1	316+GRAPHITE
19	STUD BOLT	1S	ASTM A320 B8M
20	NUT	1S	ASTM A194 B8M
21	DRIP PLATE	1	31655
22	BONNET	1	ASTM A182 F316
23	BEARING	*1	316+PTFE
24	PACKING RING	1	ASTM A276 316 L
25	PACKING	*1	GRAPHITE
27	GLAND FOLLOWER	1	ASTM A182-F316
28	GLAND FLANGE	1	ASTM A276 304
29	KEY	2	ASTM A276 304
34	BOLT	1S	ASTM A320 B8M
35	NUT	1S	ASTM A194 B8M
37	STUD BOLT	1S	ASTM A320 B8M
38	NUT	1S	ASTM A194 B8M
39	SPRING WASHER	1S	ASTM A240 304
40	STEM	1	ASTM A182 FXM-19
41	SEAT COVER	2	ASTM A276 304
42	SEAT RING	*1	PCTFE
43	INNER HEXAGONAL STUD	1S	ASTM A320 B8M
44	SEAT PUSHER	2	ASTM A182-F316
45	SPRING RETAINER	2	ASTM A182-F316
46	SPRING	1S	INCONEL X-750
47	SEAT RETAINER	2	ASTM A182-F316
48	SEAL RING	*2	GRAPHITE
49	SEAT PUSHER	2	ASTM A182-F316
50	SEAT SEAL RING	*1	INCONEL+PTFE
51	BACK RING	*1	RTFE
52	BACK RING	*1	RTFE
53	SEAT SEAL RING	*1	INCONEL+PTFE
54	SEAT RETAINER	1	ASTM A182-F316
55	SEAT RING	*1	PCTFE

ANSI

SIZE	150#	300#	600#	900#	1500#
24"					
20"					
18"					
16"					
14"					
12"					
10"					
8"					
6"					
4"					
3"					
2"					

OTHER SIZES ON REQUEST

COMPUTERIZED TEST FACILITIES



LIQUID NITROGEN
VATS FOR SIZES
THRU 24"



SPRAY NOZZLES INSIDE THE VATS
MAINTAIN PROPER AND EVEN
TEMPERATURE CONTROL



COMPUTER CONSOLE FOR
THE CONTROLLING & MONITORING
OF PRESSURES & TEMPERATURES.
ALL CHART RECORDED



PROCESS RESOURCES INC.
10440 CORPORATE DR
SUGAR LAND, TX 77478

PHONE: +1 (281) 240-0955
FAX: +1 (281) 240-5619

LOCAL DISTRIBUTOR

 / KACE-VALVES

 / KACEBALLVALVES

 / KACEVALVES